

ALL RIGHTS RESERVED. NO PORTION OF THIS PUBLICATION, WHETHER IN WHOLE OR IN PART CAN BE REPRODUCED WITHOUT THE EXPRESS WRITTEN CONSENT OF SPC TECHNOLOGY.

REVISIONS		DOC. NO.	SPC-F005	Effective: 12/21/98	Doc No. 880			
DCP #	REV	DESCRIPTION	DRAWN	DATE	CHECKD	DATE	APPRVD	DATE
170	A	RELEASED	SAS	07/21/99	JC	2/11/00	DJC	4/28/00

**SPECIFICATIONS:**

1. DO-IT-YOURSELF Ø4mm RETRACTILE SLEEVE STACKING BANANA PLUG, SCREW ATTACHMENT.
2. INSULATOR BODY: POLYACETAL
3. PLUG BODY: BRASS, NICKEL PLATED
4. CONTACT SPRING: BECU, NICKEL PLATED
5. VOLTAGE: 500V
6. CURRENT: 36A MAX.
7. TEMPERATURE: -20°C TO +80°C
8. CONDUCTOR: SIZE Ø.090 (12AWG)
9. INSULATION: Ø.156
10. STRIP LENGTH: .25 (6.4)

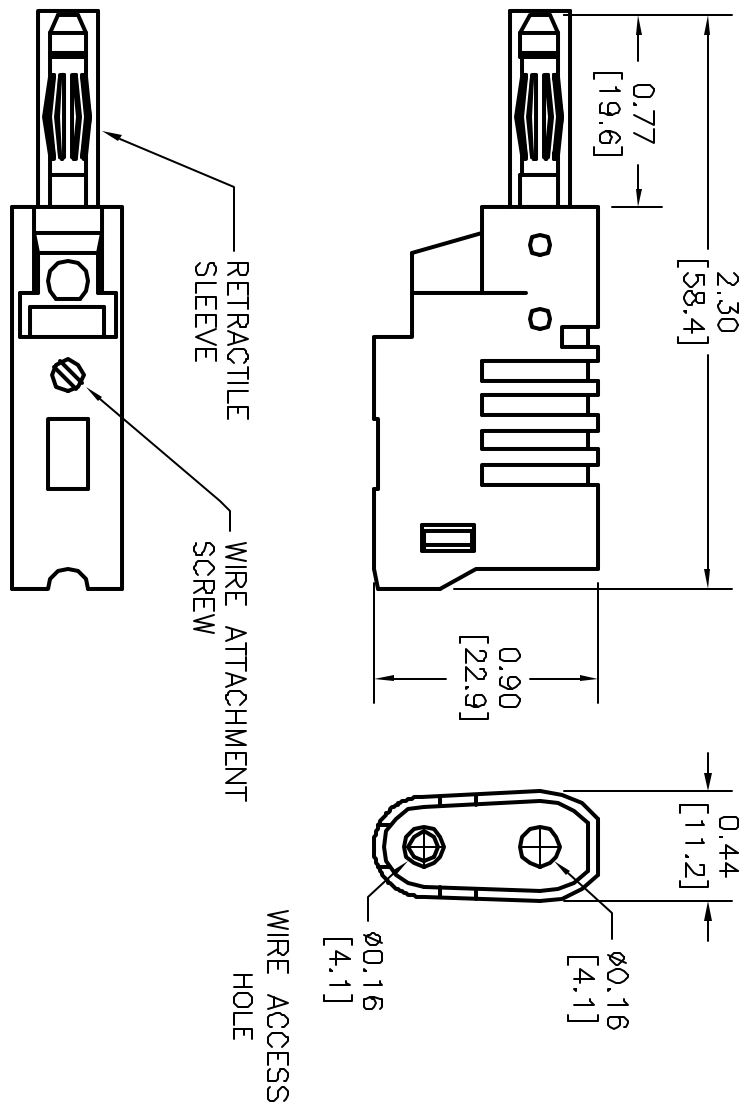

**DISCLAIMER**  
 ALL STATEMENTS AND TECHNICAL INFORMATION CONTAINED HEREIN ARE BASED UPON INFORMATION AND/OR TESTS WE BELIEVE TO BE ACCURATE AND RELIABLE. SINCE CONDITIONS OF USE ARE BEYOND OUR CONTROL, THE USER SHALL DETERMINE THE SUITABILITY OF THE PRODUCT FOR THE INTENDED USE AND ASSUME ALL RISK AND LIABILITY WHATSOEVER IN CONNECTION THEREWITH.

**SPC TECHNOLOGY**

DRAWING TITLE:  
**RETRACTILE PLUG, SCREW ATTACHMENT, RED**

Tolerances Unless Otherwise Specified	Drawn By:	DATE:
Fractions ± 1/32	SCOTT SERRITELLA	07/21/99
Decimals	CHECKED BY:	DATE:
.XX ± .01	JOHN COLE	2/11/00
.XXX ± .005	APPROVED BY:	DATE:
	DANIEL CAREY	4/28/00

SIZE	DWG. NO.	ELECTRONIC FILE	REV
A	2276	92N4638.DWG	A
SCALE:	NTS	U.O.M.: INCHES [mm]	SHEET: 1 OF 1